

# VOLVO PENTA

**Volvo Penta of the Americas**  
1300 Volvo Penta Drive  
Chesapeake, Virginia 23320-9810

## Service Bulletin

Group	Number	Version
04-3	23	01

### Water in Drive/Water in Bellows Sensors

SX-A OXi, DPS-A OXi

Distribution: M

Date: 06-2009

Binder: C

These instructions are supplemental to *Installation Manual 7745960*.

#### Install the Drive Module

**NOTE!** Some engines may already have the Drive Module installed. If the Drive Module is installed, skip steps 1 and 2.

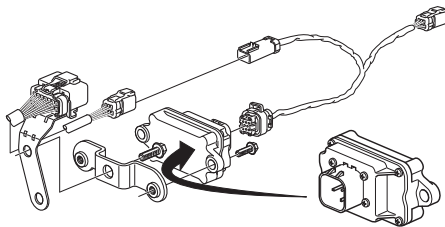

1. Remove the top bolt of the 14 pin engine wiring harness bracket and install the Ocean X drive module bracket and tighten.
2. Install the drive module onto the bracket and tighten.
3. Connect the Ocean X wire harness to the drive module.

#### Connecting the Water in Drive sensor

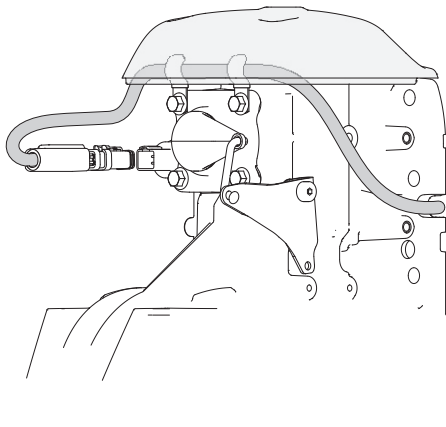

1. Feed the Water in Drive sensor cable into the slot on the starboard side of the stern-drive when installing the stern-drive to the pivot housing.

**NOTE!** Be careful not to pinch the sensor cable when installing the stern-drive.

2. Route the Water in Drive sensor cable through the wire looms at the top of the shifter mechanism and connect to the sensor.



**Caution! Make certain the wire harness does not interfere with the shift linkage.**

3. Slide the protective cover over the connector.

#### Connect Sensor Harness

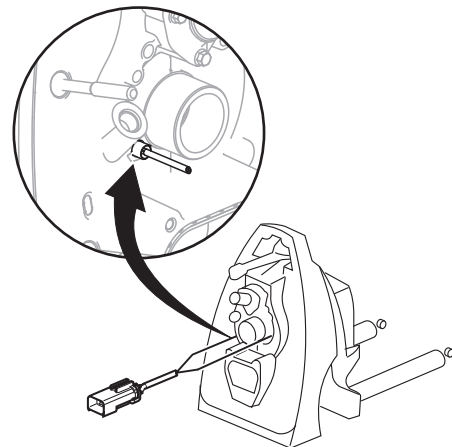

1. Connect the sensor cable to the drive module harness.

**NOTE!** The sensor connector should come with dielectric grease installed on the connector. Check to make sure the connector has grease. If the connector needs grease, use a dielectric grease. Do not use anything other than dielectric grease.

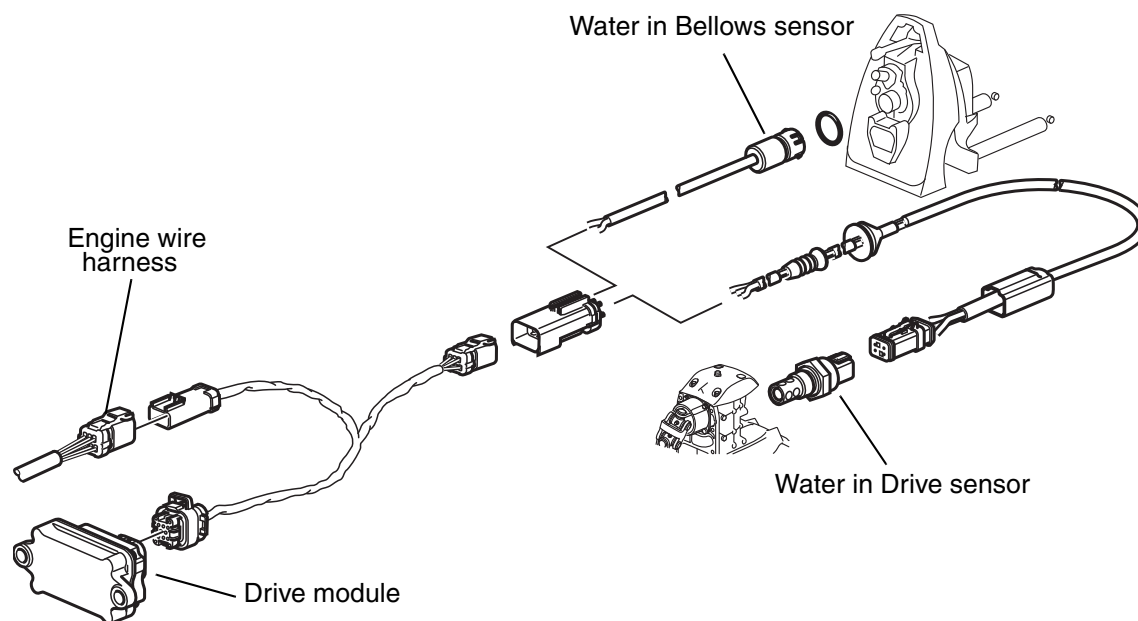

2. Connect the drive module harness to the engine wiring harness connector. The engine wire harness connector is labelled WID/WIB.



**CAUTION!** Make sure the wire harness does not interfere with any steering linkage or exhaust system components.

### Water in Drive Sensor Reset

The drive oil sensor must be reset whenever the drive oil is replaced.

**NOTE!** This procedure must be performed with the boat out of the water. If you plan to run the boat while it is out of the water, ensure that the engine has sufficient cooling water by using the flush port.

1. Ensure that the drive is trimmed to six degrees or less and that the sterndrive is as close to vertical as possible.
2. If the engine has been running, turn the engine off and allow the oil to settle for at least 30 minutes.
3. Insert the key into the ignition switch. Turn the key on but do not start the engine.
4. Slide the plastic protector on the oil sensor connector back.
5. Release on the connector and pull the plug out of the sensor and wait at least three seconds.

6. Plug the connector back in. The engine alarm will sound three beeps to acknowledge that the sensor has been reset.

**NOTE!** EVC-C2 equipped engines will not beep after reset.